

CUT12

Portable Plasma Cutting Machine



Features and benefits

- Inverter technology provide a low weight power source that can be easily maintained or carried by the welder
- CUT-i is air cooled power source to provide a non-stop work with 60% duty cycle with full power
- CUT-i provides cutting of steel, stainless steel, copper, aluminum etc.
- Self-diagnostic and different protections help in work and maintain power source
- Post flow function gives additional cooling for plasma torch

Recommended Applications



Specification

Model	UNIT	CUT12
Rated input voltage /frequency (Hz)	Hz	1 phase, 230V±15%, 50 /60Hz
Rated input capacity (KVA)	KVA	7
Rated input current (A)	No	30.6
Duty cycle (40°C)	°C	60%@40A
OCV (V)	Volt	285
Output current range (A)	Amps	15-40
Arc ignition method		HF contact
Maximum cutting thickness (mm)	mm	≤12
Clean cut thickness (mm)	mm	1-7
Air pressure (MPa)	MPa	0.5-0.8
Efficiency		>80%
Cos		0.98
Protection class	Class	IP23S
Insulation class	Class	F
Dimension (mm)	mm	391*155*298
Weight (kg /lb)	kg /lb	9 /20

Key components



Mosfet
Model: FMX-420 4S
NO. : Germany



Diode
Model: FMH23N50E
NO. : 735002-00013

Accessories

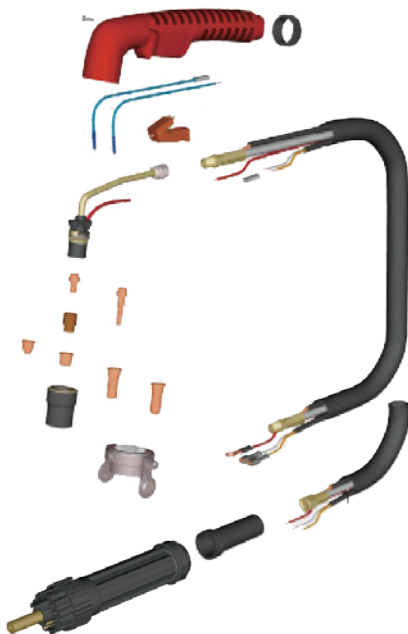

Ergocut CB50

Voltage class : M	Standard length m:4
Air consumption :165 l/min	Air pressure :5bar
Duty cycle 60%:50A	Duty cycle 100%:40A

Distributor